



300 North Harbor Drive,
Redondo Beach, CA 90277-2552
Tel: 1-310-318-8888 Fax 1-310-376-1930
www.crowneplaza.com/redondobeach
www.cpredondobeachhotel.com



HOTEL FEATURES

342 Guest Rooms, all with
Crowne Plaza Sleep Tight™ Amenities

Private balcony with marina/ocean views
in most rooms

131 Rooms with (2) Queen Beds
211 Rooms with (1) King Bed

3 Executive Suites, 4 Parlor Suites, Presidential Suite
(all suites are available with second bedroom)

RECREATIONAL SERVICES

Complimentary access to Fitness Evolution, open 24/7
European Day Spa & Salon
Men's & Women's Saunas, available 24/7
On site Beach Bike Rental
Large Pool/Sundeck/Jacuzzi/Tennis Court: 6am-10pm

MEETING & EVENT FEATURES

25,000 sq. ft. of flexible, convenient space including:
Two (2) Ballrooms, each with pre-function area
6500 sq. ft. Outdoor venue with ocean & marina views
Total of 15 Meeting rooms
Full in-house audio/visual services
Creative, flexible meeting & event menu planning

STAY-PLAY-DINE



Casual Mediterranean Restaurant & Lounge
Outdoor Patio/Private Dining Room
Splash Lounge & Lite Fare Menu
Healthy Choice Menu Options
Extended Happy Hour
(Validated 3 hr self parking)

Business to Business

Aerospace Corporation	6 miles
Alcoa/Fairchild	4 miles
American Honda	5 miles
Boeing	5 miles
Cal State - Dominguez	7 miles
Chevron	6 miles
DHL	4 miles
ExxonMobil	3.7 miles
Herbalife	5.5 miles
Home Depot Sports Arena	7 miles
Honeywell	4 miles
LA Airforce Base	5 miles
LAX	7 miles
L-3 Communications	4 miles
Lockheed Martin	6 miles
Mattel	5 miles
Northrup Grumman	4 miles
Raytheon	6 miles
Robinson Helicopter	5.6 miles
Torrance Airfield	5 miles
Toyota Motor Sales	4.5 miles
USC/UCLA	17 miles



Your Success Matters

CLUB & CONCIERGE LOUNGE

Executive Floor with Concierge Lounge offering:
Complimentary breakfast and evening reception
Private lounge with concierge services

Executive Rooms:

Top Floor, panoramic ocean views
Crowne Plaza plush robe & slippers
In-room trouser presser
Temple Spa deluxe bath and sleep amenities

CROWNE PLAZA REDONDO BEACH CODES

SABRE 29422 WORLDSPAN 1795
APOLLO 3140 AMADEUS LAX703
FEMA Property Number: Ca0922

MEETING SERVICES

Two (2) Hour Response Guarantee

Crowne Plaza's renowned Crowne Meetings Director (CMD) Our CMD is highly experienced and has received certification from both Intercontinental Hotels Group as well as Meeting Professionals International's Certified Meeting Professional (CMP).

Add to this our senior level staff to anticipate your needs and deliver on our promise; our creative, superior food and beverage - and you have the very best place to meet in Los Angeles.

Daily Meeting Debrief (DMD)

Another way to ensure we more than meet your expectation as well as bill correctly and quickly.

IHG® Rewards Club.

Discover All the Ways You Can Win with the IHG® Rewards Club. Let's go to places together. Earning is effortless. Redeeming points is simple. This winning program rewards YOU for staying or meeting at Crowne Plaza. Membership is free; sign up on-line or at hotel. For details, see ihgrewardsclub.com

SPECIAL SERVICES

Priority Club member recognition, including upgrade (as available)
European Day Spa, Beauty Salon and Tanning on site (10% discount)
Concierge Services: Tour and Restaurant Reservations; personalized planning for all your needs during your stay
Dry Cleaning/Laundry - Self serve Washers/Dryers on Site
Self Service Business Center/Foreign Currency Exchange/ATM
The Reef - Gift & Sundry Shop
High Speed Wired/Wireless Services
Two 2-Line Phones in every guest room
Complimentary daily newspaper
Valet and Self Indoor Parking/Public Transportation
Safety Deposit Boxes, plus Personal Safe in room
(additional fees & charges may apply to above services)

Recent Renovations & Upgrades

All new guest rooms & suites
Beautifully redesigned meeting and ballrooms
Gorgeous new exterior land and plant scape
Newly furnished and re-decked pool and tennis area

AREA ATTRACTIONS

Tennis/Swimming/Sauna/Jacuzzi
Fitness Evolution Health Club: Complimentary to Guests, Open 24/7
The Famous "STRAND" 21 miles of Jogging/Ocean Bike Trails
Seaside Lagoon (summer swimming)
South Bay Galleria Mall & Del Amo Fashion Ctr. (Complimentary Shuttle)
Car Rental
Roller Blades/Skates/Boards, & more (rentals)
Marina/Beach/Fishing/Water Sports/Boating
Famous Restaurants & Unique Cafes
Comedy Club/Dance Clubs/Restaurants on Hermosa Pier
Electric bike rentals and Segway tours
Redondo Beach Performing Arts Center - Live Shows
Toyota Sports Center & Ice Skating Rink
Trump International & Other Golf Clubs
Home Depot Center/Arena
Beverly Hills/Rodeo Drive
Hollywood/Universal Studios
Getty Museum/Skurbal Museums
Catalina Island (via boat)
Los Angeles Downtown/Staples Arena/Convention Center
Disneyland/CA Adventure/Knotts Berry Farm

On Property
Adjacent to Hotel
Across Street
Across Street
See Concierge
On Property
Across Street
1-3 Blocks
1-3 Blocks
1 Mile
2 Miles
2 Miles
3 Miles
5-10 Miles
6 Miles
15 Miles
20 Miles
20 Miles
22 Miles
22 Miles
30 Miles



Your Success Matters



Meetings / Destination / Southern California / Beach

Crowne Plaza Redondo Beach and Marina Hotel

Located facing onto the southern California's Pacific Ocean, the New Crowne Plaza Redondo Beach & Marina Hotel is the ideal meeting destination for small intimate corporate groups to large annual destination conventions. Enjoy the sand, surf, and shopping of Los Angeles' South Bay affordable destination - Redondo Beach.

MEETINGS BY THE NUMBERS

- ★ 20,000 sq ft NEW meeting space all on lobby level.
- ★ 342 Guest rooms and suites with city, marina, pool and ocean views.
- ★ 98.8% Meeting Satisfaction.
- ★ \$17M Renovation of meeting space, guest rooms, and lobby in past year.
- ★ 7 - Miles south of LAX airport.
- ★ 2 Hour RFP response time.

GUEST & MEETING AMENITIES

- ★ Dedicated Crowne Meeting Director - CMP. Experienced & professional from start to finish.
- ★ Concierge for personal or group offsite dining / sightseeing information or reservations.
- ★ Onsite AV services are convenient for anything last minute.
- ★ European Day Spa -massage and facials.
- ★ Scheduled daily guest shopping shuttle to Hermosa Beach and Del Amo Mall.
- ★ Pool, tennis court, whirlpool, fitness center.



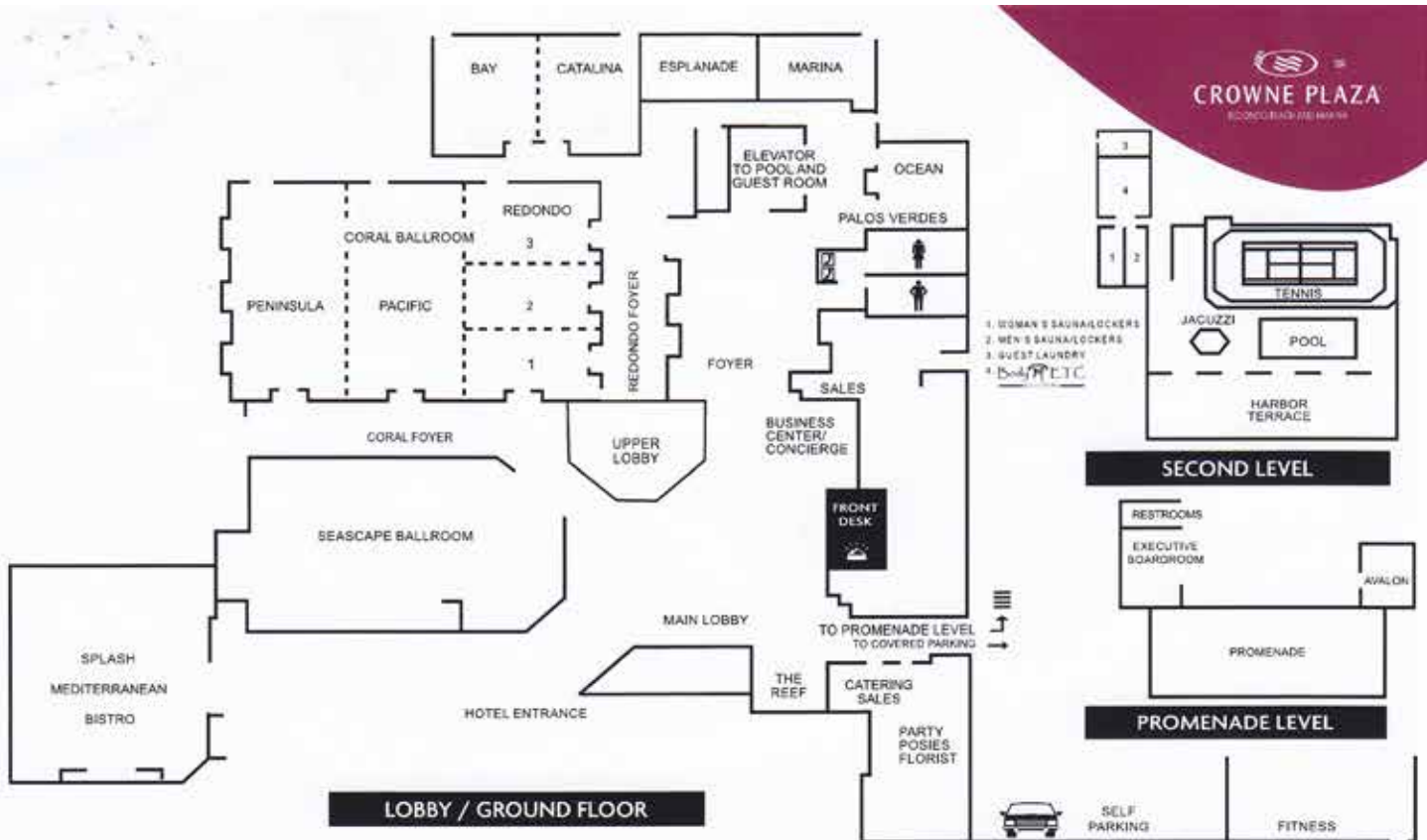

Room	Dimensions Ft	Sq. Ft.	Height Ft.	Capacity of People per Set Up							
				Reception	Banquet	with Dance Floor	Theater	Classroom	Conference U-Shape	Exhibit (8' x 10')	
Coral Ballroom Foyer		1500	13	200							
Redondo Foyer		2000	13	250							
CORAL BALLROOM	94x80	7250	13-15.5	1000	550	500	900	400			40
Peninsula, Pacific, Redondo (ea)	31x80	2480	13	300	180	140	250	115	50		12
Redondo Salon 1	30x40	1200	13	100	50		90	50	30		
Salon 2 & 3	30x40	1200	13	100	50		90	50	30		
SEASCAPE BALLROOM*	70x52	3640	12	320	220	180	200	90	46		20
Bay, Catalina (ea)	38x26	988	11.5	75	60		80	40	30		
Bay, Catalina (combination)	38x52	1976	11.5	175	120	80	130	60			
Esplanade, Marina (ea)	25x21	525	11.5	35	30		40	20	16		
Ocean	24x25	600	11.5	45	40		40	20	16		
Palos Verdes	13x29	377	11.5	25	20		30	10	15 (conf. set only)		
Mezzanine-Promenade*	68x31	1900	8	175	100	80	90	50	40/34		
Avalon	17x15	255	8						10 (conf. set only)		
Executive Boardroom	29x19	551	8		14				14		
Splash Bistro					140						
Splash Show Kitchen					50						
Private Dining Room										17 (conf. set only)	
Patio											
Harbor Terrace*	136x46	6256		600	450		550				

*Ocean View
**All functions booked on Harbor Terrace must have approval of the Director of Catering
*Ballroom capacity does not include elaborate staging
**All Classroom standard sets are based on 3 attendees per 6' table.

